

# POWERTEC®

## Router Table Top



### **⚠ WARNING**

For your own safety, read all of the rules and precautions before operating tool.

### **⚠ WARNING**

Always follow proper operating procedures as defined in this manual even if you are familiar with use of Router Table Top or any tool used with Router Table Top. Remember that being careless for even a fraction of a second can result in severe personal injury.

Before using another tool with this product, always read, understand and follow the instructions and safety warnings in the owner's manual for that tool. If you do not have the owner's manual, obtain one from the tool's manufacturer before using it with this product.

You must be familiar with the use of any tool or accessory used with Router Table Top. The supplier cannot be held responsible for any accident, injury or damage incurred while using Router Table Top with any tool.

It is the responsibility of the purchaser of this product to ensure that any person using this product reads and complies with all instructions and safety precautions outlined in this manual and the operating manual of the tool being used prior to use.

### **⚠ WARNING**

Some dust created by operation of power tool contains chemicals known to the State of California to cause cancer, birth defects or other reproductive harm. To reduce your exposure to these chemicals, work in a well ventilated area and work with approved safety equipment. Always wear OSHA/NIOSH approved, properly fitting face mask or respirator when using such tools.

### **⚠ CAUTION**

Do not modify or use Router Table Top for any application other than that for which it was designed.

### **FOLLOW ALL STANDARD SHOP SAFETY PRECAUTIONS, INCLUDING:**

- Keep children and visitors at a safe distance from work area.
- Keep work area clean. Cluttered work areas invite accidents. Work area should be properly lit.
- Do not use power tools in dangerous environments. Do not use power tools in damp or wet locations. Do not expose power tools to rain.
- TURN OFF AND UNPLUG all power tools BEFORE making any adjustments or changing accessories.
- Be alert and think clearly. Never operate power tools when tired, intoxicated or when taking medications that cause drowsiness.
- Wear proper apparel. Do not wear loose clothing, gloves, neckties, rings, bracelets or other jewelry which may get caught in moving parts of the tool.
- Wear protective hair covering to contain long hair.
- Wear safety shoes with non-slip soles.
- Wear safety glasses complying with United States ANSI Z87.1. Everyday glasses have only impact resistant lenses. They are NOT safety glasses.
- Wear face mask or dust mask if operation is dusty.
- A guard or any other part that is damaged should be properly repaired or replaced. Do not perform makeshift repairs.
- Use safety equipment such as featherboards, push sticks and push blocks, etc., when appropriate.
- Maintain proper footing at all times and do not overreach.
- Do not force woodworking tools.

### **⚠ CAUTION**

Think safety! Safety is a combination of operator common sense and alertness at all times when tool is being used.

### **⚠ WARNING**

Do not use the Router Table Top until it is completely assembled and you have read and understood this entire operating manual and the operating manual of the tool being used with Router Table Top.

**SAVE ALL WARNINGS AND INSTRUCTIONS FOR FUTURE REFERENCE**

## UNPACKING

Check for shipping damage. Check immediately whether all parts and accessories are included.

ITEM	DESCRIPTION	QTY
AA	Table Top (24" wide x 32" long x 1" thick)	1
BB	Flat head locking screw (1/4"-20)	4
CC	Hexagon set screw 1/2"-20*19.5LX (3/8"-24 internal thread)	4
DD	Hex nut 1/2"-20	4
EE	Hex nut 3/8"-24	4
FF	Adjustment screw 3/8"-24 (1/4"-20 internal thread)	4
GG	Main Aluminum Insert	1
HH	Reducing Rings (include solid insert, 1", 1-7/8" & 2-5/8" openings)	4
II	Ring Wrench	1
JJ	M5 Starting pin with M6 Insert	1
KK	Struts	2
LL	Screw 3/16" x 5/8" L	8
MM	Leveling Screw 1/4"-20 x 5/8" L	8
NN	Hex Wrench	1

Figure 1

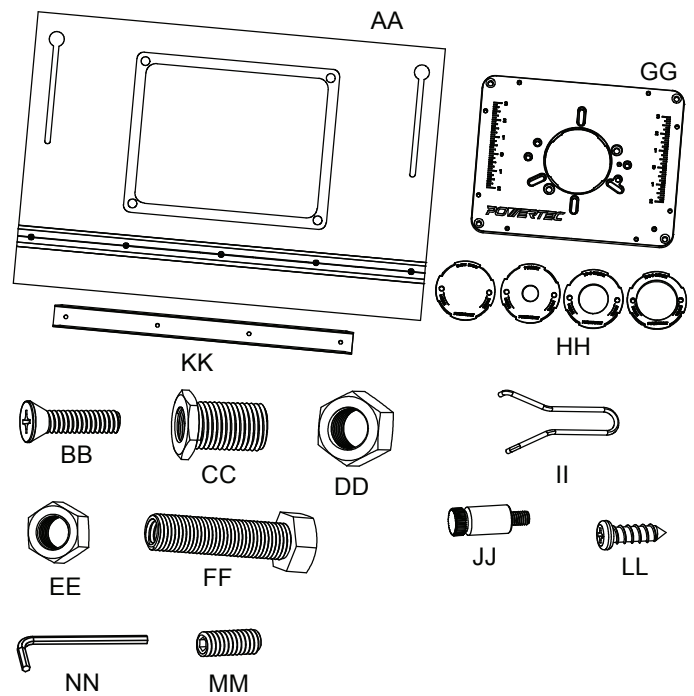

## TABLE TOP ASSEMBLY

- See Figure 2. Turn Table Top (AA) over with back facing up. Place Struts (KK) in position over predrilled holes. Using Screws (LL) secure Struts to back of Table Top.

Figure 2

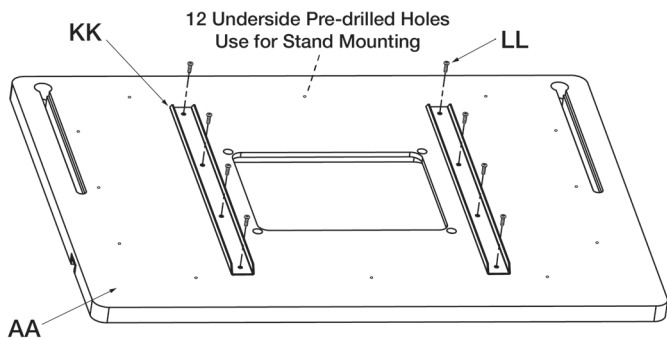

**NOTE:** Observe the 12 pre-drilled holes on table underside. Use these for mounting the router table onto POWERTEC UT1006 Router Table Stand. Due to the T-Track on table top, ALWAYS be aware of location of T-Track before drilling. Use appropriate length hardware. Do not drill through.

- See Figure 3. Place Hexagon Set Screws (CC) into the recessed hole openings. Hand-tighten Hex Nut (DD) onto the bottom of each Hex Set Screw (CC) then tighten against the bottom of the table. Install Hex Nut (EE) onto Adjustment Screw (FF) then thread it into Hexagon Set Screw (CC). DO NOT tighten at this time. Repeat for all four holes.

Figure 3

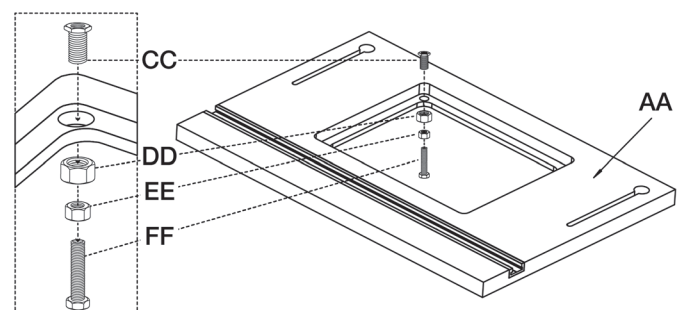

## ROUTER HOLE PATTERNS

- On the chart find the model and the corresponding letter for your router.
  - Find the corresponding letters for your router in Figure 4.
  - NOTE:** Some routers have more than one option.
  - Place the insert onto the router and line up the first letter with the appropriate hole and then rotate the plate until all holes for the pattern line up. Install and tighten the machine screws.

Figure 4

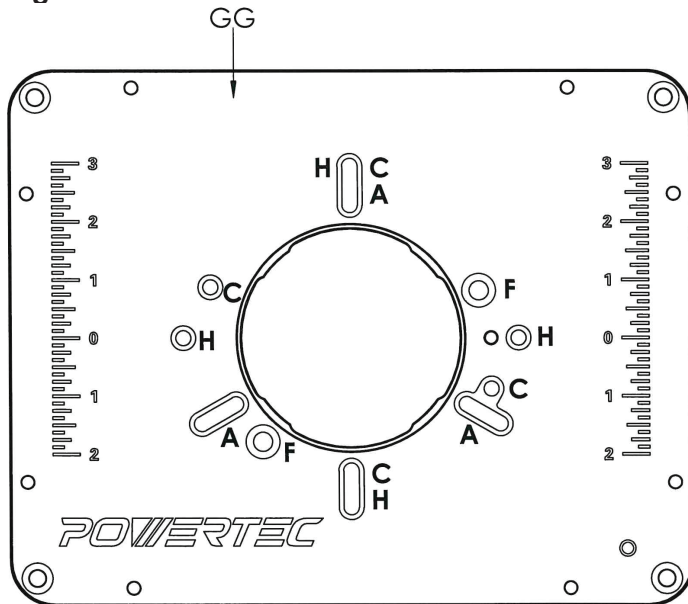

PORTER CABLE*	A	690 Series		A	8529 / 7529	
	H	7518 / 7519 / 7538 / 7539				
DEWALT*	F	DW621		A	DW616 Series	
	F	DW625		A	DW618 Series	
Craftsman*	C	315 275 000		A	315 175 060	
	A	315 175 040		A	315 175 070	
	A	315 175 050				
Bosch*	A	1617 (fixed base)		A	1618	
	A	1617 (plunge base)		A	MR23 Series	
Makita*	A	RF1101				
Ryobi*	C	R1631K				
Milwaukee*	A	5615	A	5616	A	5619
	H	5625-20				
Fein*	F	FT 1800				
Elu*	F	177				
Hitachi*	A	M-12VC				
Triton*	H	TRA001		H	MOF001	

\* PORTER-CABLE, DeWALT, Craftsman and Elu are trademarks of The Stanley Black & Decker Corporation—Bosch is a trademark of the Robert Bosch Tool Corporation—Makita is a trademark of Makita Corporation—Ryobi is a trademark of Ryobi Limited and is used by Techtronic Industries Company LTD—Milwaukee is a trademark of Techtronic Industries Company LTD—Fein is manufactured by C. & E. Fein GmbH—Hitachi is a trademark of Hitachi, Ltd.

**IMPORTANT:** Store router sub-base in a convenient place. It will be needed when removing router from router table and during handling.

- See Figure 5. Using the screws for attaching the sub-base to the router, attach router base to Aluminum Insert GG).

**NOTE:** Depending on the thickness of your router sub-base, it may be necessary to purchase longer screws. Make certain the screws are long enough to fully thread into the router base. If you are mounting a fixed-base router, install the motor unit in the router base.

Figure 5

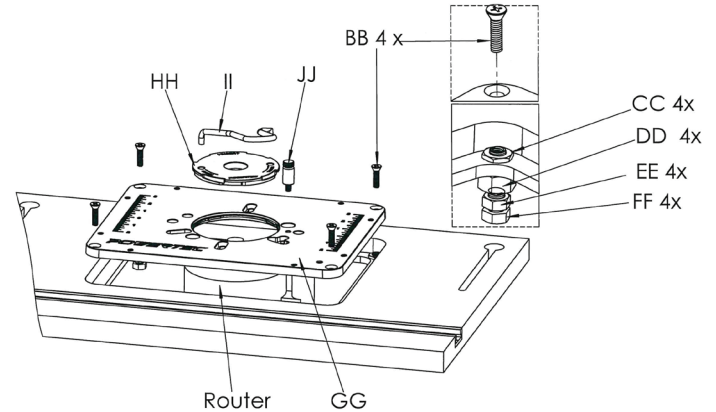

- Place Aluminum Insert (GG), with the router attached, into the table opening, resting it on Adjustment Screws (FF). Reaching under the table, turn Adjustment Screws (FF) until the insert is flush with the table. Use a straight edge to verify the insert plate is flush with the tabletop. Once flush, tighten Nuts (EE) against Hexagon Set Screws (CC). If not flush, fine-tune Adjustment Screws (FF) until Aluminum Insert (GG) is flush with the tabletop. Tighten each assembly.

**NOTE:** An additional set of Leveling Screws (MM) is included to fine tune the leveling of Insert Plate (GG) if needed. Insert the 8 Leveling Screws (MM) into the holes (two on each side). Use the 3mm Hex Wrench (NN) to adjust the Leveling Screws (MM) until the Insert Plate is properly level with the tabletop.

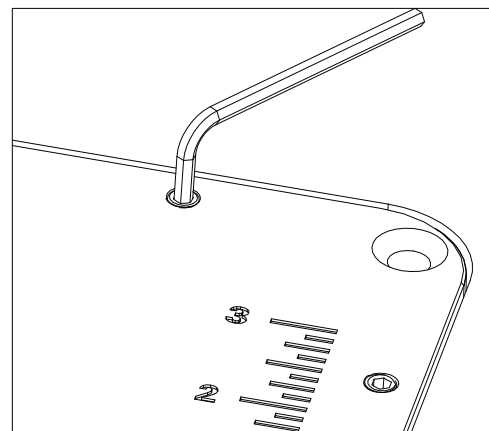

- Thread the four Flat head Screws (BB) through the countersunk holes in the insert plate and into the center hole on each adjustment screw and tighten, locking the insert plate in place. Some adjustment of the lock down screws and adjustment screws may be necessary to fine-tune the alignment.
- Choose the Reducing Ring (HH) appropriate for the job. Using Ring Wrench (II), in a counterclockwise motion, secure to Aluminum Insert (GG). When needed, thread the Starting Pin (JJ) into the threaded hole in the insert plate and tighten.

## REDUCING RINGS

See Figure 6. There are four Reducing Rings (HH) for flexibility in matching the size of the insert opening to the diameter of the router bit in use:

1. A solid insert, to be bored for any custom size
2. An insert with a 1" opening
3. An insert with a 1-7/8" opening
4. An insert with a 2-5/8" opening.

### To install a reducing ring:

Simply drop one Reducing Ring (HH) into the Aluminum Insert (GG) opening and attach using the Ring Wrench (I I) provided.

Figure 6

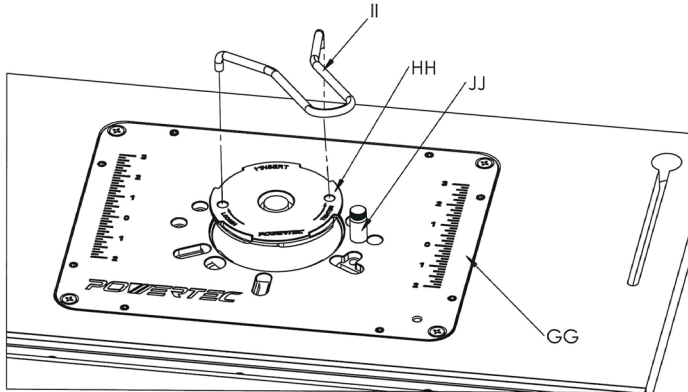

## STARTING PIN

To use the Starting Pin (JJ), begin with your workpiece touching the pin, but not in contact with the router bit. Slowly pivot the workpiece into the bit until the workpiece makes contact with the bit guide bearing. Always feed the workpiece so the router bit rotates against (not with) the feed direction. With the workpiece in solid contact with the guide bearing, ease the workpiece off of the starting pin and feed the workpiece against the guide bearing.

### **WARNING**

Use the Starting Pin (JJ) when routing along curved edges and only with router bits that have a guide bearing. When routing along straight edges, always use the fence.

## GENERAL MAINTENANCE

### **WARNING**

When servicing, use only identical replacement parts. Use of any other parts may create a hazard or cause product damage. To ensure safety and reliability, all repairs should be performed by a qualified service technician.

### **WARNING**

Keep the Router Table Top dry, clean, and free from oil and grease. Always use a clean cloth when cleaning. Never use brake fluids, gasoline, petroleum based products or any strong solvent to clean the Router Table Top. Chemicals can damage, weaken or destroy plastic which may result in serious personal injury.

Visit us on the web at [www.powertecproducts.com](http://www.powertecproducts.com)



Put these instructions and the original sales invoice in a safe, dry place for future reference.

Southern Technologies, LLC  
Chicago, IL 60606